

NOTE:  
USED 12" DRAWER IN  
BATH 1 ILO 18"

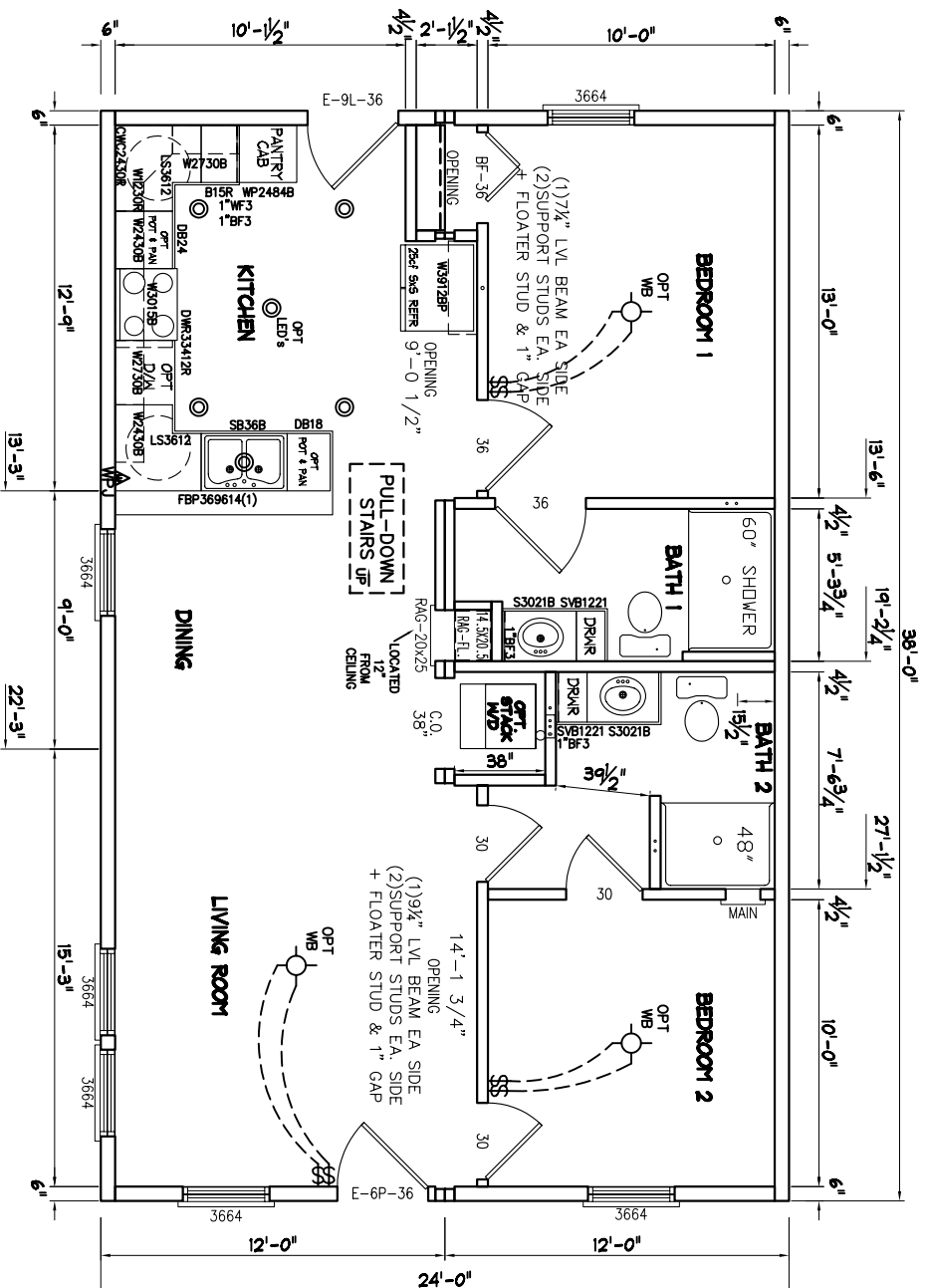

ALL APPLIANCES ARE SHOWN FOR REPRESENTATION ONLY. INSTALLATION AND/OR SHIPPING OF APPLIANCES DEPENDS ON SALES ORDER.

TOTAL AREA = 912sf

8' CEILING

DRAWN	WM	DATE	6/14/2021
REV.	C-GLH	DATE	7/1/21
SCALE	3/16" = 1'-0"		

**1st FLOOR ORDER**

**SOUTHERN MODULAR / DRAUGHN**  
38'-0" X 24'-0"  
12-CP-38' Draughn

**201**