

NOTE:  
A 32" EXTERIOR 6-PANEL WAS USED FOR THE  
BASEMENT ENTRY!!

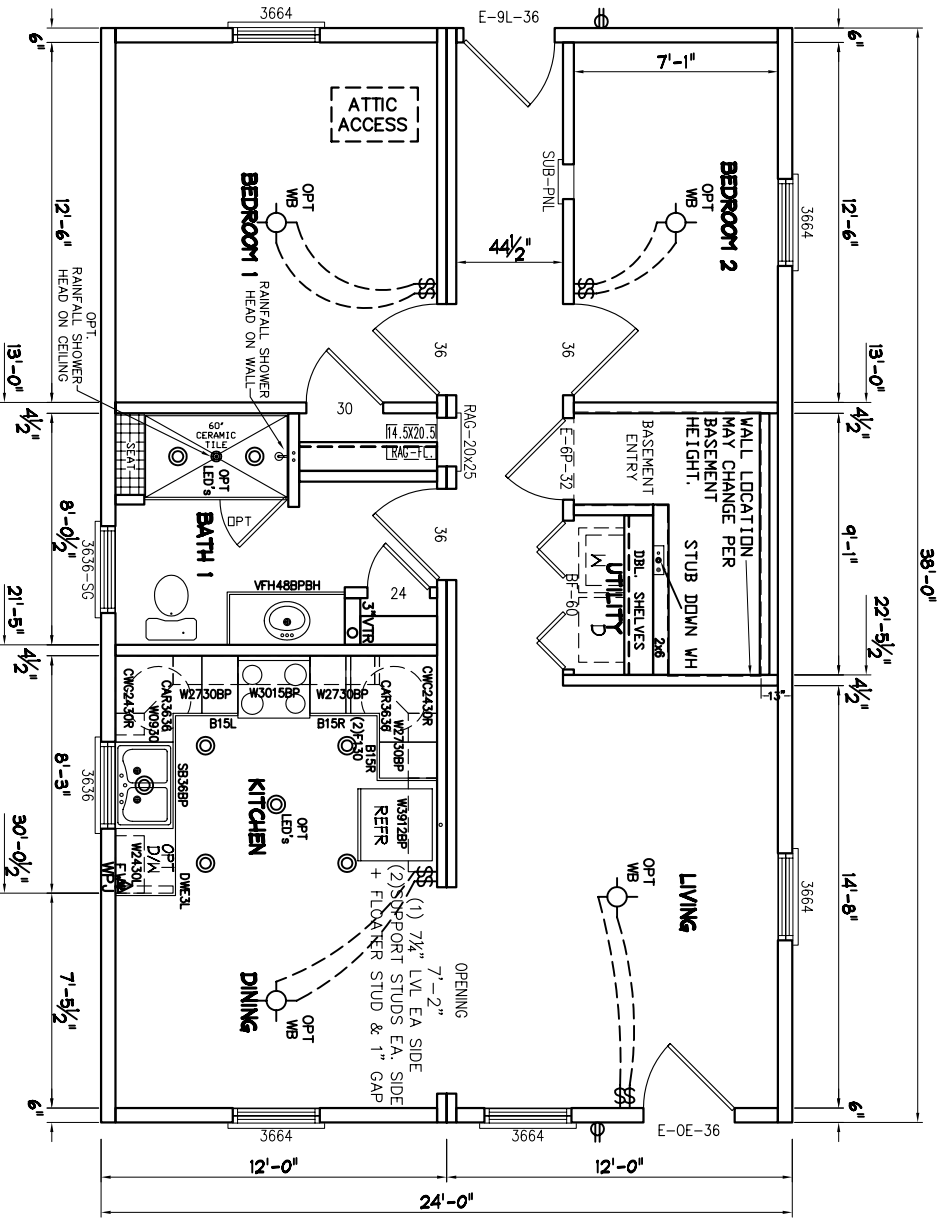

ALL APPLIANCES ARE SHOWN FOR  
REPRESENTATION ONLY. INSTALLATION  
AND/OR SHIPPING OF APPLIANCES DEPENDS  
ON SALES ORDER.  
TOTAL AREA = 912sf

8' CEILING

DRAWN	GLH	DATE	8/2/19
REV.		DATE	
SCALE	3/16" = 1'-0"		

**1st FLOOR ORDER**

**SOUTHERN MODULAR / WELLS**  
38'-0" X 24'-0"  
12-CP-38' Wells

**201**